

Parameters	Configuration
Overall Dimension(m)/ Area(m ²)	5.0*8.0*2.3*3.9m / 40m ²
Interior Area(m)/ projected area(m ²)	4.85*5.35*2.2*3.15m / 25.9m ²
Colours	Khaki
Tent Parameters	PVDF architectural membrane fabric(900g) Waterproof pressure(3000KPA) UV protection(UV800+) Fire-retardant (GB8624) Class B1 Mold-resistant, self-cleaning, PVC lifespan of 15 years+
Frame Parameters	Main Pipe: (80*80mm)Galvanized Steel Pipe、(2.0mm)Thickness Argon Arc Welded, Hot-Dip Galvanized Corrosion-Resistant Galvanized Steel Plate Outdoor-Specific Baking Paint Treatment (Resistant To Sunlight And Rain)
Inner Tent Parameters	TC environmental cotton(430g) Waterproof pressure(≥10KPa) UV protection(UV50+) Tear resistance: 2112N in the radial direction/1056N in the weft direction Mold-proof, mosquito-proof, breathable
Accessory Parameters	Galvanized bolts、Tear-resistant mesh、Nickel-plated copper snap fasteners 8mm self-tightening anti-aging climbing rope



LAYOUT

FLOOR PLAN



5.0*8.0*2.3*3.9m/40m²

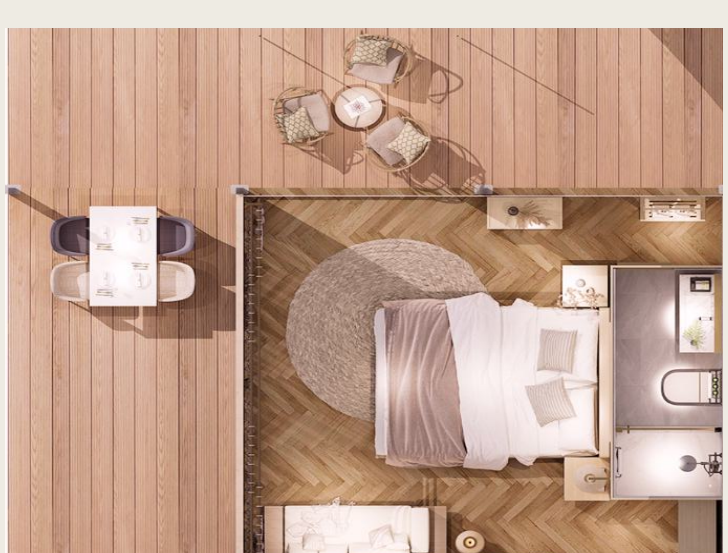

Framework



Connecting Pipe



Roof Structure



Floor-To-Ceiling Glass
Curtain Door